



EFM® AUSTIN PRO SPEAKER USER MANUAL

Introduction:

The EFM® Austin Pro Bluetooth Speaker works with tablets, notebooks and smartphones that are Bluetooth compatible. Enjoy up to 10 hours of music and hands-free calling. To get the best results when using this device, please read this manual first.

Package Contents

- 1 x EFM® Austin Pro Bluetooth Speaker (40W)
- 1 x 0.5m Type-C Charging Cable
- 1 x 0.5m 3.5mm AUX Cable
- 1 x 18W Wall Charger (Dual Port)
- 1 x User Manual & Warranty Details

Important Safety Precautions

When using a portable Bluetooth speaker, basic safety precautions should always be followed, including the following:

1. Keep this product and its charging cable away from excessive heat.
2. Do not operate this device with a damaged cable or after it has malfunctioned or has been damaged in any manner.
3. Do not disassemble your device.

Charging Your Speaker

1. Plug the Type-C connector of the included charging cable to the Type-C charging port on your speaker. Then plug the USB-A connector end of the cable into a wall charger.

NOTE: The internal battery of your speaker takes approximately three hours to charge when completely drained.

2. When connected to power, an orange LED light will illuminate to indicate that the unit is charging.
3. The orange LED light will go out when your speaker is fully charged.

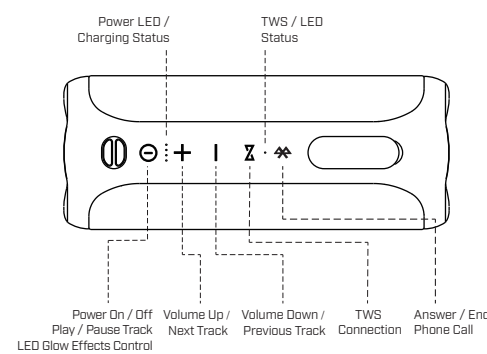

Power On / Power Off

Power On: Press and Hold the Power Button for 2 seconds to turn the speaker on, the LED status light will flash on the front of the speaker to confirm it has been activated.

Power Off: Press and Hold the Power Button for 2 seconds to turn the speaker off, the LED status light on the front of the speaker will go out to confirm it has been deactivated.

Pairing Bluetooth Devices to Your Speaker

In order to pair your Bluetooth compatible device with the EFM® Austin Pro Speaker for the first time, follow the steps below:

1. Make sure the Bluetooth compatible device you wish to pair is located close to the speaker.
2. Press and Hold the Power Button for 2 seconds to turn the speaker on, the LED status light will flash on the front of the speaker to confirm it has been activated.
3. Activate the Bluetooth function on your compatible device. (Please refer to the manufacturer's instructions for confirmation of this function)
4. Search Bluetooth devices and select "EFM Austin Pro". If required, enter the password "0000" to confirm pairing.
5. When pairing is successful, you will hear a confirmation sound from the speaker and your device will show the "EFM Austin Pro" speaker connected in your Bluetooth list.

Bluetooth Music Playback

1. Open the music player, select a song to play, press the button to pause music and then press again to resume music.
2. Play music and press the button to increase the volume, press and hold the button to change to next song.
3. Play music and press the button to decrease the volume, press and hold the button to change to previous song.

Bluetooth Phone Calls

1. Press the button to answer an incoming call, Press the button again to end the call.

Aux-in Mode

1. If you have a device with a 3.5mm Aux-in port you can connect the EFM® Austin Mini Speaker together with it using the included 3.5mm Aux cable.
2. Plug one end of the 3.5mm Aux connector cable into the speakers Aux-in port and the other connector end into your compatible device. The speaker will sound to confirm the connection is successful, ready for media playback.
3. Press the button to play music and then press again to mute.

NOTE: When the speaker is in Aux-in mode, pressing / only controls the volume.

Battery Status

When the speakers battery is running low you will be prompted by an alert sound to plug-in the charging cable, to recharge the speaker.

Multi-Colour LED Glowing Effects Control

The EFM® Austin Pro Speaker displays multi-coloured LED glowing effects on the top of the product. There are three functions that can be controlled by pressing the button twice to move through each of them one by one. The three functions are as follows:

1. Multi-Colour LED Glowing Effect - Transitional (default function).
2. Multi-Colour LED Glowing Effect - On / Off.
3. Multi-Colour LED Glowing Effect - Off.

Power Bank Function:

To use your speaker as a Power Bank to charge other devices, connect a USB cable into the output port on speaker and connect the other end to the device you want to charge. Press power button for 3 seconds to power on the speaker and then the power LED will be lit on. When the device is fully charged, you can pull out the cable and power off the speaker.

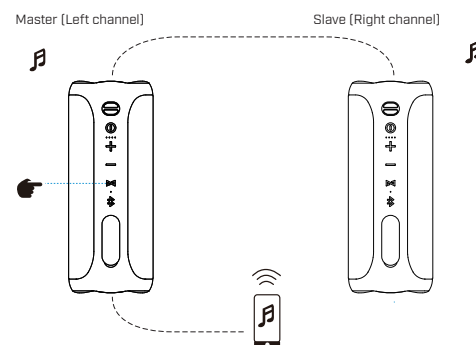

TWS Mode (True Wireless Stereo)

With the latest TWS technology any two speakers from the EFM® Austin range (EFM® Austin Mini | EFM® Austin | EFM® Austin Pro) can be connected together via their TWS pairing feature, for the ultimate audio experience. It is important to understand how this process works. The speaker your device initially connects to is called the "Master Speaker", as shown in the image above. The "Master" can then connect to any secondary EFM® Austin speaker, called a "Slave", which receives the audio from your device through the "Master Speaker".

1. Ensure the EFM® Austin Pro is powered on and not paired with any devices. If already paired, disconnect from device.
2. Power on the second speaker, ensuring it is not paired with any devices. If already paired, disconnect from device.
3. Hold the button on the MASTER speaker, the LED light will flash orange. (Choose one of the two speakers as the MASTER)
4. The second speaker will connect automatically, displaying an orange solid LED to confirm the TWS connection has been made with the MASTER (The LED on the MASTER will flash green to confirm connection).
5. Once the TWS connection has been confirmed you will hear a confirmation sound. At this point pair your device via bluetooth with the MASTER speaker.
6. When you have paired your device via Bluetooth, both speakers will then be ready for audio playback.
7. Press to disconnect the TWS connections and press and hold to clear all connections.

Bluetooth Phone Calls in TWS Mode

1. Press the button to answer an incoming call, Press the button again to end the call.
2. While connected via TWS mode only the MASTER speaker can be used to answer and end phone calls.

Music Playback in TWS Mode

1. While in TWS Mode Press the button on the MASTER or Slave speaker to play / pause the track, both speakers will automatically synchronize any actions with each other.
2. Press the / button on MASTER or Slave speaker to control volume.
3. Press and hold the / button on MASTER or Slave speaker to select next or previous track.

Note: When paired with a second Austin speaker (Slave speaker) the volume and control buttons will work the same as on the MASTER speaker, synchronizing. Additionally your paired device will control both speakers at the same time.

Reset Pairing

To disconnect or un-pair from a Bluetooth device, hold the button until you hear notification. You may have to "Forget Device" from your Bluetooth settings to re-pair your device again.

Waterproof

EFM® Austin Pro is rated IPX7, this product is protected against the effects of immersion in up to 1 metre of water for 30 minutes.

IMPORTANT:

To ensure that the EFM® Austin Pro is waterproof, please remove all cable connections and tightly close the cap, exposing the EFM Austin Pro to liquids without doing so may result in permanent damage to the speaker. And do not expose Havans to water while charging, as doing so may result in permanent damage to the speaker or power source.

Specifications

Bluetooth version: V5.0
Maximum Output: 40W
Built-in Power: Li-ion 10000mAh
Wireless Working Frequency: 80HZ-20KHZ
Wireless Transmission Distance: up to 10M
Charging Time: approx. 4 hours
Playback Time: 8-10 hours (at 60-70% Volume)
Charging Input: DC 5 V / 3A
Size: Dia 88mm x 220mm



myefm.com

THE EFM® 2 YEAR WARRANTY

Our goods come with guarantees that cannot be excluded under the Australian Consumer Law. You are entitled to a replacement or refund for a major failure and compensation for any other reasonably foreseeable loss or damage. You are also entitled to have the goods repaired or replaced if the goods fail to be of acceptable quality and the failure does not amount to a major failure.

EFM® warrants that its products are free from defects in materials or workmanship for up to 2 years from the date of purchase. EFM® will repair or replace any product which is defective in materials or workmanship at no charge to the customer (for parts or labour). The customer is responsible for any transportation costs.

This warranty does not cover or apply to any damage or defects caused by the incorrect installation of the IPX7 product, through your modification of the IPX7 product, cosmetic damage, damage caused by accident, or damage caused by abuse or improper use of your IPX7 product, including using the IPX7 product in environments where the relevant IP rating limitations are exceeded. This warranty does not apply to any consequential loss or damages which may be incurred through your use of the IPX7 product, including but not limited to damage of any nature caused to any products used in conjunction with the IPX7 product.

Please do not expose your IPX7 product to chlorinated water. Over time, chlorinated water can corrode the rubber seals on the IPX7 product. Accordingly, prolonged use in chlorinated water is not recommended.

To claim under the warranty, you need to return the faulty EFM® product to the place of purchase (at your expense) with a valid proof of purchase. If you are not able to return the product to the place of purchase, you can contact:

EFM Customer Service Department
PO BOX 584, Belmont WA 6104
P: 1300 069 336 (1300 0 MYEFM)
E: info@myefm.com

Important: For the avoidance of any doubt, this 2 Year Warranty applies to your purchased EFM® product only, and not to any device to which the EFM® product is affixed or used in conjunction with. Whilst we stand by our products, EFM® will not be liable for any damages of any nature caused to any such device from incorrect use of the product.

For more information visit myefm.com.