

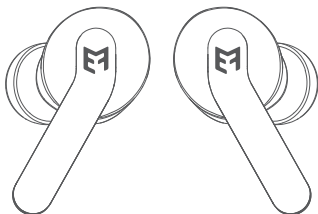

myefm.com

EFM® TWS ANDES EARBUDS WITH ACTIVE NOISE CANCELLING USER'S MANUAL



Introduction:

Thank you for choosing the EFM® True Wireless Stereo Andes Earbuds! You can use this product with all iOS and Android compatible Bluetooth® devices to stream music and enjoy handsfree calling. In order to get the best results when using these earbuds, please read this manual first.

Pack contents:

- 1 x EFM® TWS Andes (True Wireless Stereo) Earbuds
- 1 x EFM® TWS Andes Charging Pod
- 1 x 0.5m USB Type-C Charging Cable
- 1 x User manual
- 3 x Earbud tips (Sizes: Small / Medium / Large)

THE EFM® 2 YEAR WARRANTY

Our goods come with guarantees that cannot be excluded under the Australian Consumer Law. You are entitled to a replacement or refund for a major failure and compensation for any other reasonably foreseeable loss or damage. You are also entitled to have the goods repaired or replaced if the goods fail to be of acceptable quality and the failure does not amount to a major failure.

EFM® will happily repair or replace defective goods for up to 2 years from the date of purchase. This warranty is against defects in the EFM® goods purchased and does not cover damage caused by the incorrect use or installation of the goods, or by modifications, or by accident.

To claim under the warranty, you need to return the faulty product to the place of purchase (at your expense) with a valid proof of purchase. If you are not able to return the product to the place of purchase, you can contact:

EFM® Customer Service Department
PO BOX 684, Belmont WA 6104
P: 1300 069 336 (1300 0 MYEFM)
E: info@myefm.com

For more information visit myefm.com

This warranty is in addition to other rights and remedies of the consumer under Australian Consumer Law for Consumer Electronic Devices and Home Entertainment Products.

01. PRODUCT SPECIFICATIONS

Model:	EFM® TWS Andes with ANC
Active Noise Reduction:	28dB
Bluetooth Version:	5.0
Impedance:	32Ω
Scope of frequency:	20Hz~20,000Hz
Charging:	USB Type-C
Earbud Battery Capacity:	70mAh (Each Earbud)
Charging Pod Battery Capacity:	340mAh
Earbud Recharge Time:	1.5 Hours
Charging Pod Recharge Time:	1.5 Hours
Combined Playback (With Pod)	Up to 32 Hours
Playback Time [ANC On]:	8 Hours

- ① TOUCH CONTROL BUTTON
- ② LED INDICATOR
- ③ SILICONE EAR TIPS
- ④ SOUND CAVITY
- ⑤ CHARGING PINS
- ⑥ MICROPHONE
- ⑦ CHARGING POD

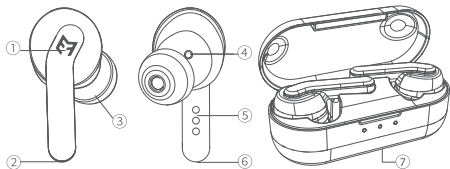

02. AUTOMATIC ON/OFF

Auto On: Take the earbuds out of the Charging Pod and the earbuds will automatically turn on.

Auto Off: Put the earbuds back into the Charging Pod and they will automatically turn off.

03. BLUETOOTH PAIRING

To facilitate a better user experience, pairing between the left earbud and the right one is done automatically.

Pairing between the earbuds and the mobile device:

Take out the earbuds from the Charging Pod, the main earbud (right) will enter into pairing mode automatically (red and green lights on the main earbud flicker alternatively), please then enable the Bluetooth function on your device to search, pair and connect to the EFM® TWS Andes.

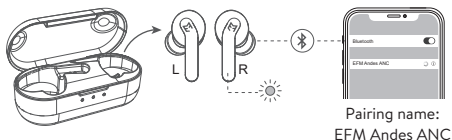

04. ACTIVE NOISE CANCELLATION FUNCTION

While the two earbuds are in use, hold the Touch Control Button on the Right Earbud for 2 seconds. This will toggle on the Active Noise Cancellation function, doing the same action again will toggle it off. Both actions are preempted by a chime.



05. CALL CONTROL (L/R BUTTON)

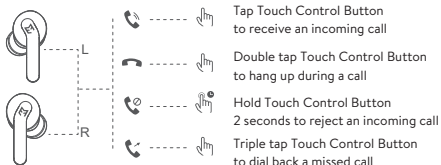

06. MUSIC CONTROL

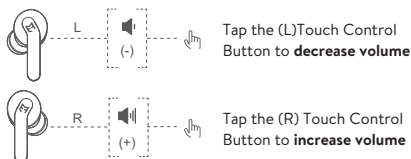
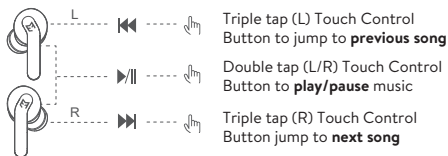

07. VOICE ASSISTANT

When two earplugs are in use, enable the function of voice assistant (such as siri, and Google assistant)



08. CLEAR BLUETOOTH PAIRING RECORD

Take the two earbuds out of the Charging Pod, and then put them back into the Pod. When the LED indicators on the earbuds light red for charging, hold the Touch Control Buttons on both earbuds for 10 seconds simultaneously. When the indicator flickers for 3 times, pairing information will be cleared.

NOTE: This action only clears BT pairing between the EFM® TWS Andes and any devices previously connected to it.

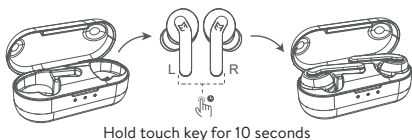

09. LED STATUS INDICATOR

DEVICE STATUS	LED STATUS INDICATOR
On	Green light is on for 1 second
Off	Red light is on for 1 second
Standby	No light
Connect again	No light
Earbud in Pairing mode	Red and green LEDs flicker
Earbud charging mode	Red light is on
Earbud is fully charged	No light
Charging Pod is fully charged	3 LED lights are on