

Our goods come with guarantees that cannot be excluded under the Australian Consumer Law. You are entitled to a replacement or refund for a major failure and compensation for any other reasonably foreseeable loss or damage. You are also entitled to have the goods repaired or replaced if the goods fail to be of acceptable quality and the failure does not amount to a major failure.

EFM® will happily repair or replace defective goods for up to 2 years from the date of purchase. This warranty is against defects in the EFM® goods purchased and does not cover damage caused by the incorrect use or installation of the goods, or by modifications, or by accident.

To claim under the warranty, you need to return the faulty product to the place of purchase (at your expense) with a valid proof of purchase. If you are not able to return the product to the place of purchase, you can contact:

EFM Customer Service Department

61 Belmont Avenue, Belmont WA 6104

P: 1300 069 336 (1300 0 MYEFM)

E: info@myefm.com

Important:

The 2 Year Warranty covers EFM® product and not your device. Whilst we stand by our products, EFM® will not be liable to any damages caused to your device from accidental impact. For more information visit myefm.com/warranty-support



15W WIRELESS VENT MOUNT CHARGER



PACK CONTENTS:

- PACK CONTENTS:
- 1 X EFM® 15W WIRELESS VENT MOUNT CHARGER
- 1 X EFM® 18W FAST CHARGE CAR CHARGER
- 1 X 1M USB-A TO TYPE-C CHARGE CABLE
- 1 X INSTRUCTION MANUAL

TECHNICAL SPECIFICATIONS:

Parameter	Value
Input	5V/9V 2A
Output	10W

IMPORTANT INFORMATION:

- Please read the instruction manual before using this product.
- Do not modify, repair or dismantle the wireless charge pad. Doing so may result in fire, electric shocks or a complete breakdown of the product all of which are not covered under warranty.
- Do not use any diluent or volatile liquids to clean the product surface.
- Do not use the product in a hazardous location.
- The product should be kept in a dry and ventilated environment, do not store in an area of high humidity and/or high temperature.
- Do not use unsupported devices on the wireless charge pad, only devices that support the Qi wireless standard are recommended.
- Do not place foreign objects on the charging pad whilst in use, this may damage both the charging pad and the mobile device.
- Do not cover or obstruct the wireless charge pad's vents, this may lead to overheating and cause damage to the device.

INSTALLATION INSTRUCTIONS:

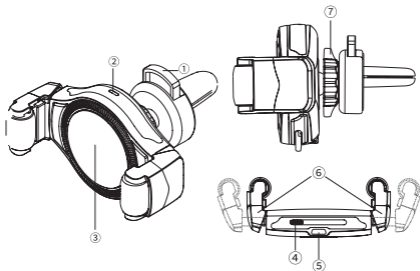

- | | |
|----------------------|----------------------------|
| 1. Clamp Button | 5. Micro USB Charging Port |
| 2. Indicator Light | 6. Adjusting Arms |
| 3. Wireless Charging | 7. Fastener |
| 4. Adjusting Button | |

1. Press the button on the side of the vent mount and insert into the car's air vent, releasing the button to secure.
2. Next, insert either the arm or vent mount into the cradle unit (depending on the desired use) and partially screw into place so that the cradle unit is still movable.
3. Position the cradle unit into the ideal position then tighten the screw fully to secure.

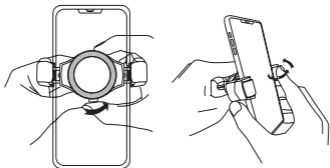

4. Maximize the arm width by pressing the adjusting button
5. Use index finger to rotate the roller buckle when your phone is securely place.

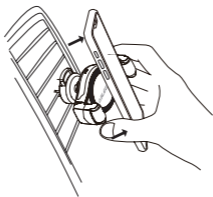

7. To release your phone, use index finger to rotate the roller buckle.
8. Plug the Type-C connector into the EFM 18W Car Charger included in this pack, then place your Qi-Supported mobile device on the charging area of the wireless car charger.